

Hotel Customs

① Check In



Please produce your passport/ID when you check in as we are required to take a copy.
(by hotel law article 6.)

② Your Room



Take off your shoes before entering the room.

Slippers are for use outside of your room only.



Please refrain from dragging your luggage across the Tatami as Tatami damages easily.

Please understand that the Tokonoma is an area for decoration only and refrain from using it.

For safety, items such as wet towels should not be put directly on the heater. Please use the towel rack provided.



For safe keeping please put your valuables in the safe provided.



You will find our complimentary items in the drawer.
Yukata -dressing gown, Haori-room jacket, bath towel, toothbrush, and face towel.
Feel free to keep the toothbrush and face towel.

③ How to Make Green Tea



Put the tea bag into the tea pot.



Add hot water from the hot water pot provided.



After about 1 minute the tea is ready to serve.



Remove the tea bag and put on the dish provided.
(You can use one tea bag about 5 times.)



Please eat the tea cake freely.

④ How to Put on your Yukata
(Follow the pictures below.)

* If you feel cold, we provide Haori (a room jacket).

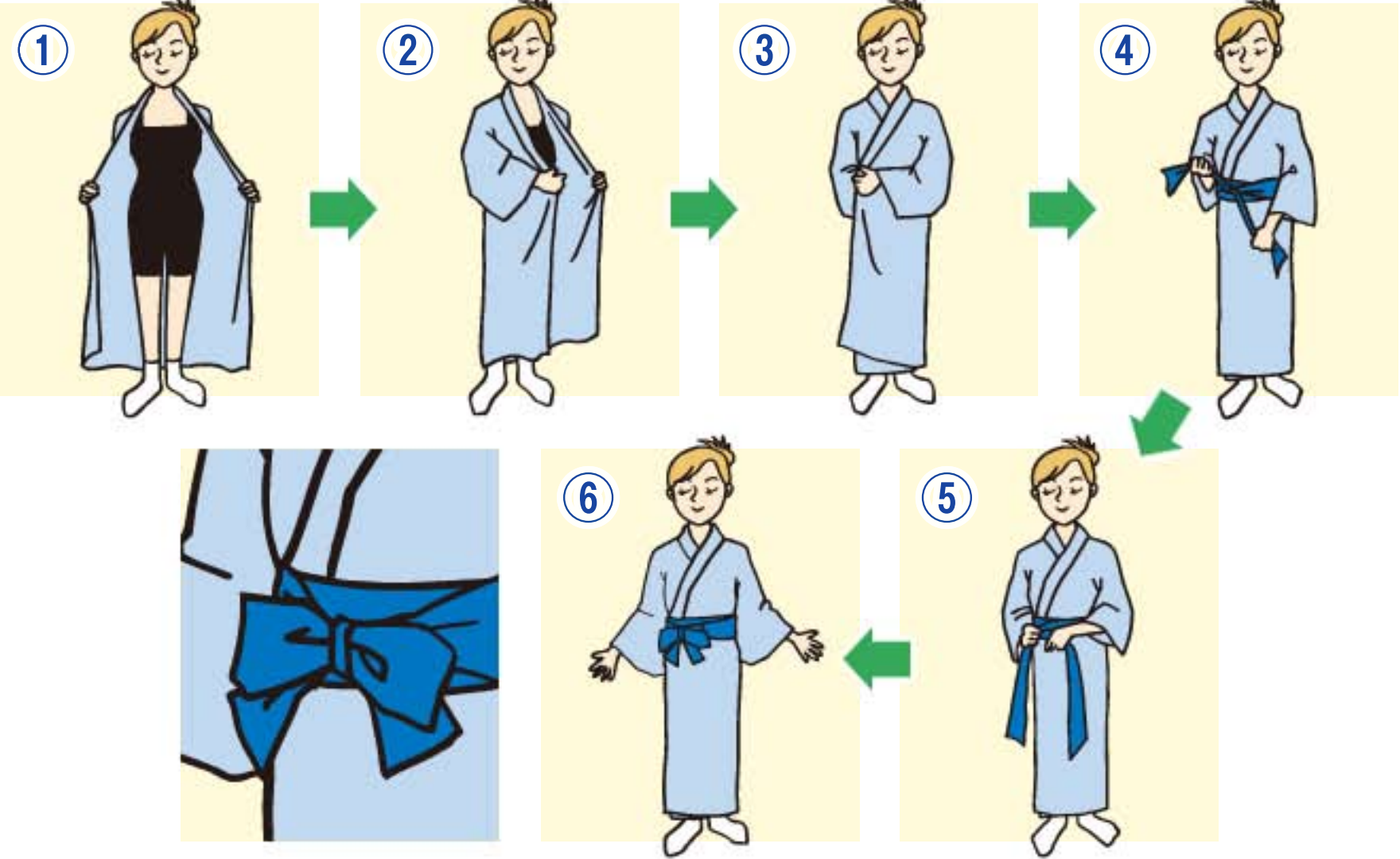

⑤ Our Hotel Customs



Feel free to wear your Yukata and slippers around the hotel.



Please refrain from wearing them out side. The Yukata is a complimentary item for use during your stay. (Please don’ t forget to leave it behind!)

⑥ How to Use a Japanese Toilet

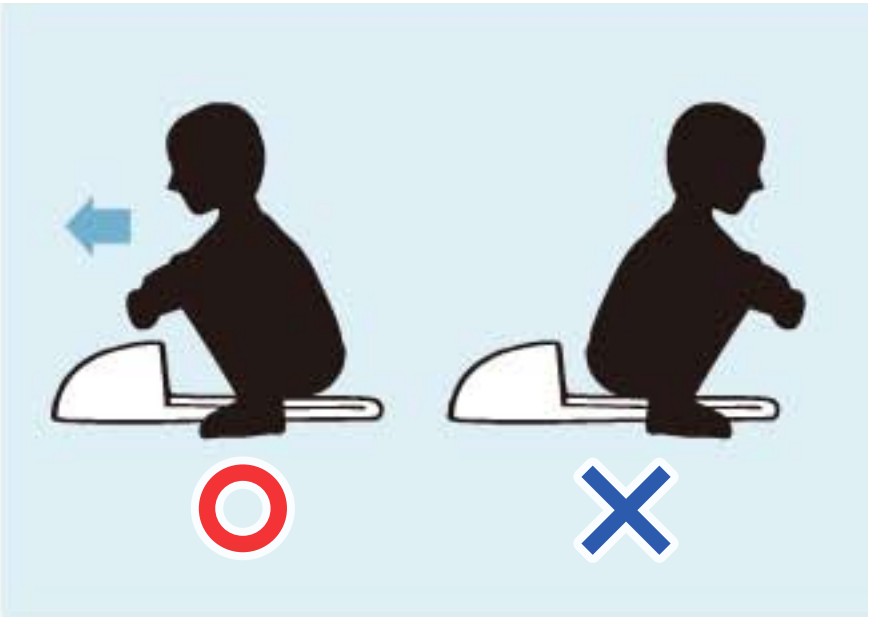

Follow the pictures.
Be sure to flush the toilet.
Toilets are public (except for special rooms) so be patient and respect the queue.

⑦ The changing rooms



For safe keeping, please leave your valuables in the safe in your room as there are no lockers.

Swim suit should not be worn in the public bath.

⑧ How to Use the Public Bath

* Please do not bring bath towels into the bathing area.



Please rinse your body with the bath water before entering the bath.



Afterwards make sure to also wash your body and head in the shower stalls before entering.



Please refrain from drinking alcohol.



No bath products should be added to the bath.



Avoid putting your towel in the bath.

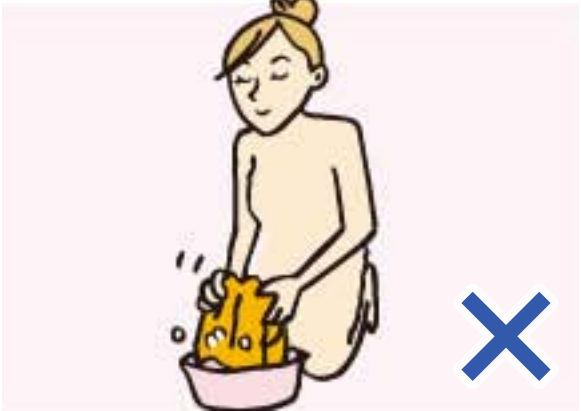

Personal items should not be washed.

⑨ Meal Times



Meals are served in the restaurant (not in the room). Please come to the restaurant at your appointed meal time.
Complimentary tea is provided. Other drinks can be ordered in the restaurant and will be charged to your room.

⑩ Bed Time



Futons are ready to use simply lay them out on the floor.

Food and drink are permissible in the rooms. Please show consideration to the other guests by keeping your noise levels down both late at night in the room and when star gazing out side.

⑪ Check Out



Hand your room key in at reception.